

| PART NO. | DESCRIPTION | COATING |
|----------|-----------------------------|--|
| 1511062 | MACH 5/16 IN. 3/4t GALV | MECHANICAL PLATE PER ASTM B-695 TYPE II, CLASS 12 |
| 1515840 | MACH 5/16 IN. 3/4t GALV RED | MECHANICAL PLATE PER ASTM B-695 TYPE II, CLASS 12, THEN PAINT RED PER QCP-4906 |

| REV | DESCRIPTION | BY | DATE | CN |
|-----|---|----|-------------|-------|
| A | SUPERSEDE 1511062 WITH CHANGES; ADD 1515840 | | 24-APR-2020 | 22970 |

材质：4140 (42CrMo)热处理
 数量：51069PCS
 表面：机械镀锌12um以上
 包装：纸箱散装 (18KG内)

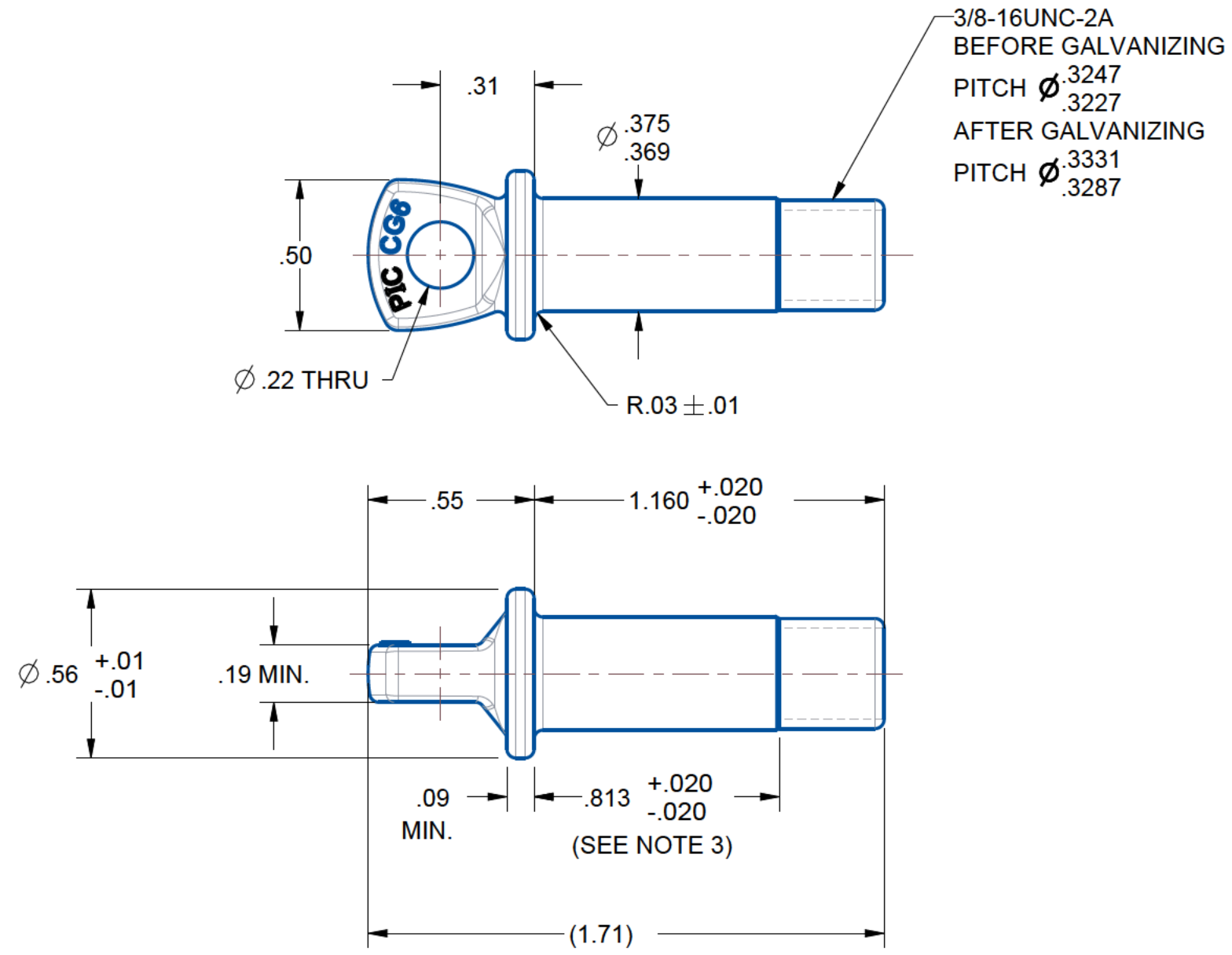

标记要求：标记打在钉头或杆部末端字符 "CG"、"6" 及 PIC
 (批次/供应商代码) 字高 0.06", 凸起高度 0.010" ~ 0.030" 头部样式：
 可因制造方式不同而变化但关键尺寸必须合格握距测量方法 (重要)：
 把螺母用手拧紧到螺栓上测量从肩部下沿到螺母支撑面的距离

- NOTES:
- APPROVED MARKING LOCATIONS ARE PIN HEAD AS SHOWN OR END OF SHANK.
- USE .06 SIZE CHARACTERS FOR "CG", "6", AND PIC, RAISED .01 ⁺⁰² _{-.00}
 - HEAD STYLE MAY VARY TO ACCOMMODATE METHOD OF MANUFACTURE. CRITICAL DIMENSIONS ARE TOLERANCED.
 - THIS DIMENSION IS THE GRIP LENGTH AND SHALL BE MEASURED BY THREADING A NUT SNUGLY ON THE BOLT AND TAKING THE DIMENSION FROM UNDER THE SHOULDER TO THE BEARING SURFACE OF THE NUT.

| | |
|-----------------|-------------------|
| REFERENCE: | N/A |
| COATING: | SEE TABLE |
| MATERIAL: | AISI 4140 |
| HEAT TREATMENT: | QUENCH AND TEMPER |
| HARDNESS: | BHN 269-311 |

| | | |
|---|----------------------------|---|
| INTERPRET DIMENSIONS AND TOLERANCES PER ASME Y14.5-2009 | | |
| THIRD ANGLE PROJ | UNLESS OTHERWISE SPECIFIED | |
| | TOLERANCE | ALL DIMENSIONS ARE IN INCHES DIMENSIONS ARE PRIOR TO COATING BREAK ALL SHARP EDGES MACHINED SURFACES: ¹²⁵ /√ |
| SCALE: 2:1 | 2 PL DEC ± 0.03 | |
| DO NOT SCALE | 3 PL DEC ± 0.030 | |
| | ANGLES ± 0.5° | |

| | |
|---|------|
| UNLESS OTHERWISE SPECIFIED FORGING TOLERANCES SHALL CONFORM TO FIA STANDARD | |
| DEFAULT DRAFT | 7° |
| DEFAULT CORNER RADIUS | .03 |
| DEFAULT FILLET RADIUS | .03 |
| MISMATCH MAX. | .015 |

| | | | |
|-----------------|-----------|--------------------------------------|-------------|
| STATUS: | IN WORK | SUPERSEDES: | 1511062 (0) |
| PROPOSAL NO.: | N/A | PRODUCT LINE: | 209 |
| CALCULATED WT.: | 0.051 LBS | DATE: | 24-Apr-2020 |
| ENGINEER: | | DRAWN: | |
| TITLE: | | PIN SHACKLE SCREW MACH 5/16 IN. 3/4t | |
| PART NUMBER: | | 3644656 | |
| SHEETS: | | 1 of 1 | |